

**ISSUE CHANGES –**

**Fitting Instructions**

ISSUE	DATE	CHANGES
1	03.01.24	FITTING INSTRUCTIONS CREATED

**Safety Warning**

These Fitting Instructions are for informational purposes only. Shelbourne Reynolds makes no representation or warranty, express or implied, regarding the information provided herein. Under no circumstances will Shelbourne Reynolds have any liability to you for any loss or damage resulting from the use of these instructions or reliance on any information provided. It is extremely dangerous to carry out any work on a machine while it is under power. Never remove or reattach any parts unless the machine is fully turned off and disengaged.

Please read all safety instructions contained in your operator's manual and observe all safety signs attached to the Stripper header. Your use of these instructions is solely at your own risk. Please always use proper safety equipment.



*Refer to the Operators Manual for additional information and Safety Procedures*

*These instructions are worded if the kit was being installed while the header is mounted on a combine, to have the stripping rotor set in the slowest position and implement the safe stop procedure.*

*If not the pulley drive and actuator may need rotating and cycling to assist.*

**Recommended Tools List:**

**Sockets:**

- 13mm Socket + Extension
- 17mm Socket
- 19mm Socket
- 24mm Socket (for 1/2" Impact)
- 30mm Socket

**Other Tools**

- Large Pry Bar
- 2 Medium Pry Bars
- Hammer
- Punch
- Tie Wraps
- Anti-Seize/Copper Slip
- Thread Lock (Loctite)

**Wrenches:**

- 13mm Wrench
- 19mm Wrench
- 2x 30mm Wrenches

**Allen Hex Wrenches:**

- 3mm Allen Hex Wrench
- 6mm Allen Hex Wrench

Machine / Model	Stripper header / CVS & XCV	Year / SN#	All Years
Combine Specific Parts			

- CASE – No Extra Parts
- JOHN DEERE – Sprocket (15T) and Multi coupler
- AGCO – Sprocket (12T) and Multi coupler
- CLAAS – Sprocket (13T) and Chain Half Link

**THE POSITION OF THE DECALS SHOULD BE PLACED NEAR THE IDENTIFICATION PLATE OF THE MACHINE.**

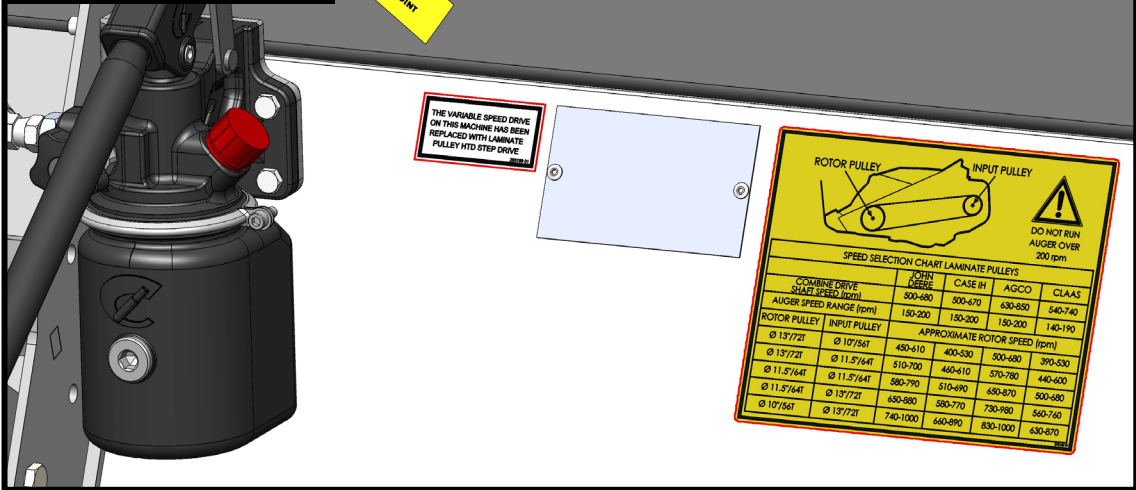

**REMOVE THE OLD SPROCKET AND INSTALL NEW ONE IF PROVIDED WITH YOUR KIT. TO BE DONE BEFORE STEP 30. KITS WITH NEW SPROCKETS ARE AS FOLLOWS, KIT-19089/91/94.**

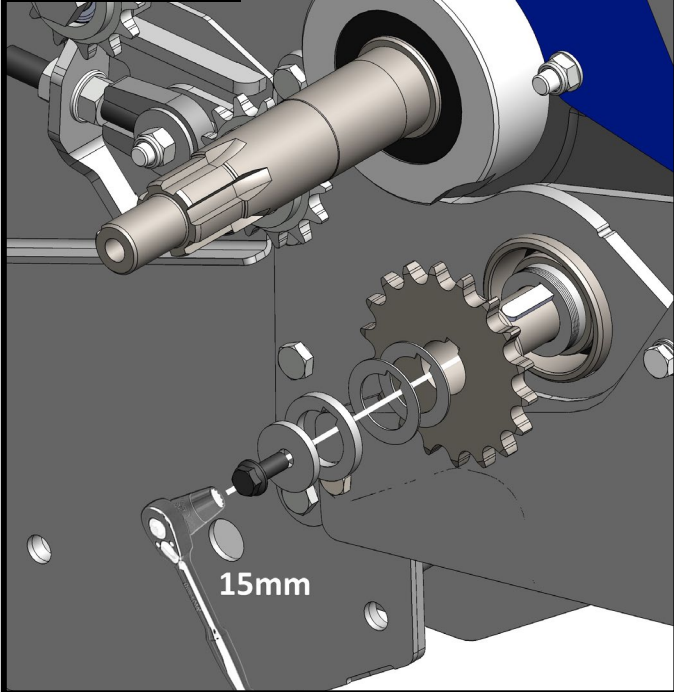

**REFIT THE CHAIN AND TENSION ACCORDINGLY. THE CHAIN LENGTH MAY NEED TO BE ADJUSTED TO SUIT THE NEW SPROCKET SIZE.**

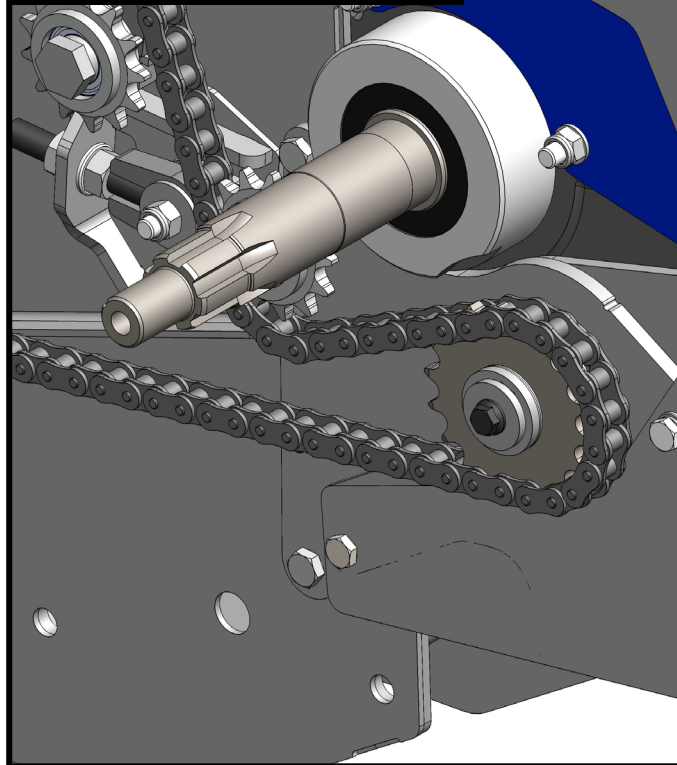

Machine / Model | Stripper header / CVS & XCV

Year / SN#

All Years

1 – RUN THE MACHINE UNTIL THE ROTOR SPEED IS MINIMUM. FRONT PULLEY = FULLY CLOSED. REAR PULLEY = FULLY OPEN.



STOP THE MACHINE AND IMPLEMENT THE SAFE STOP PROCEDURE.

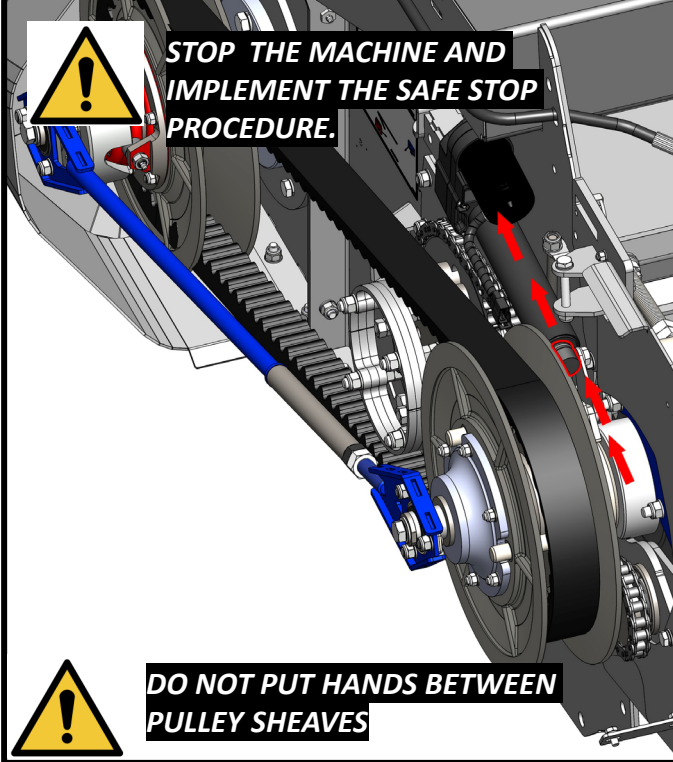

DO NOT PUT HANDS BETWEEN PULLEY SHEAVES

2 - REMOVE THE GUARD.

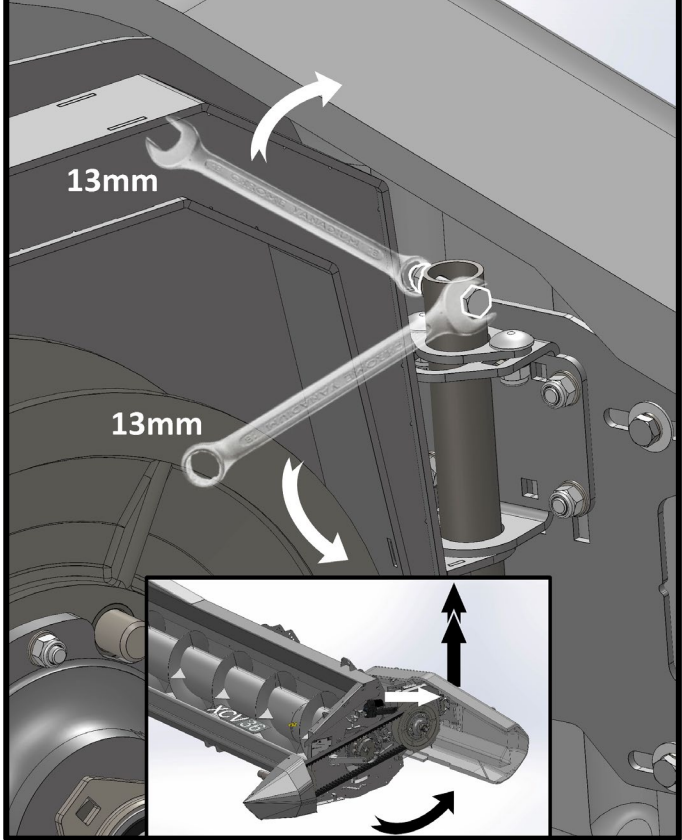

3 – REMOVE FRONT STEEL NOSE CONE, BY REMOVING THE FOUR BOLTS.

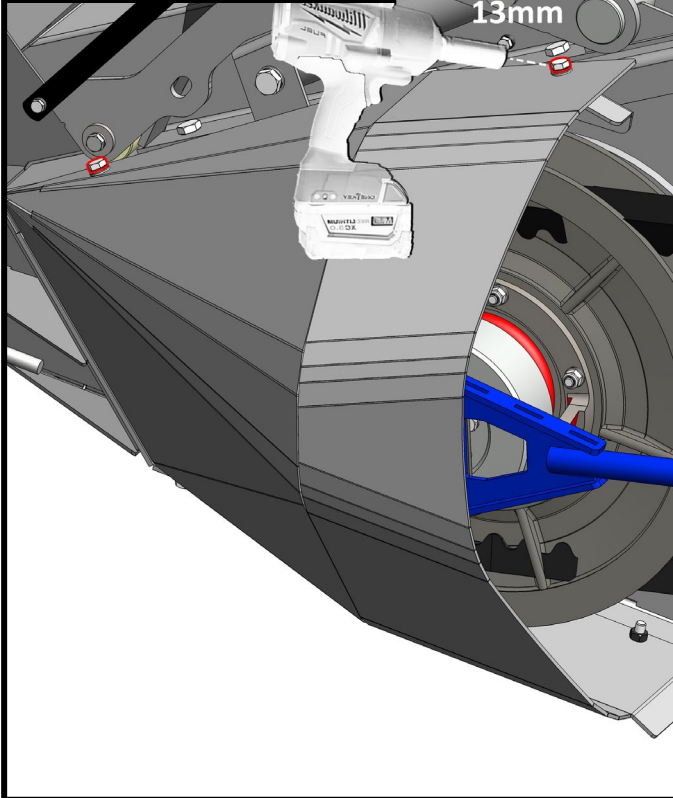

4 – LOOSEN THE TIE ROD.

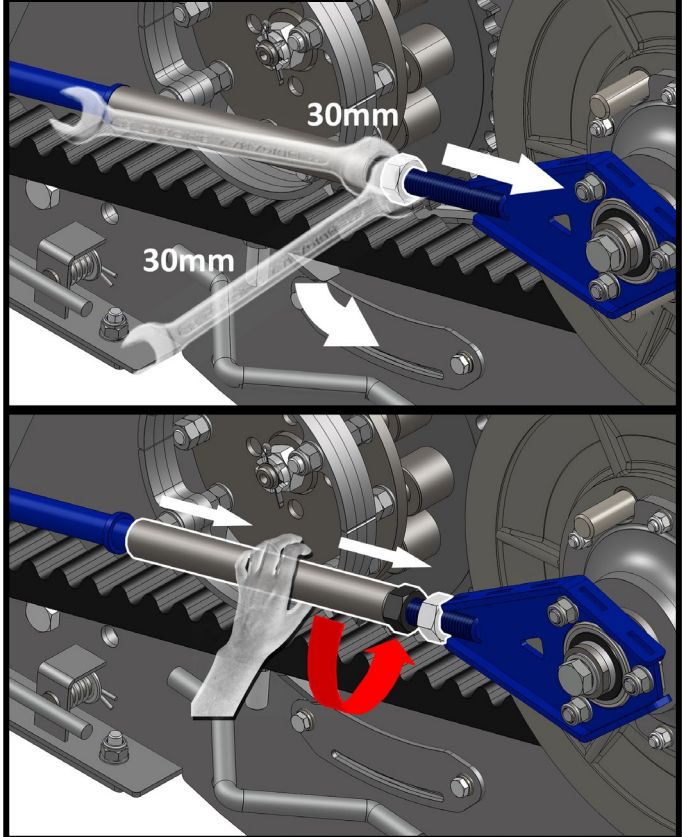

Machine / Model | Stripper header / CVS & XCV

Year / SN#

All Years

**5 – REMOVE THE TIE ROD SUPPORT FASTENERS.**

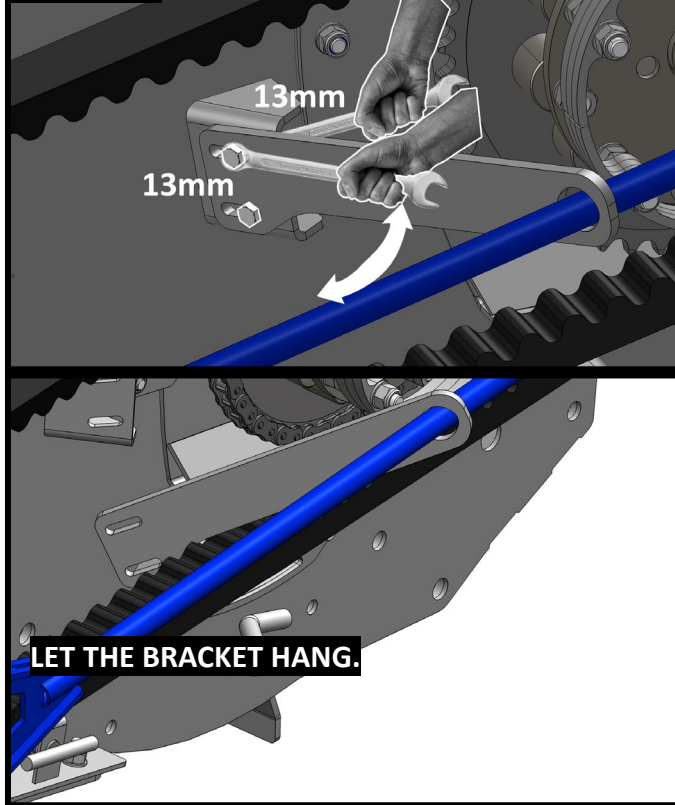

**6 – LOOSEN TIE ROD BEARING GRUB SCREWS.**

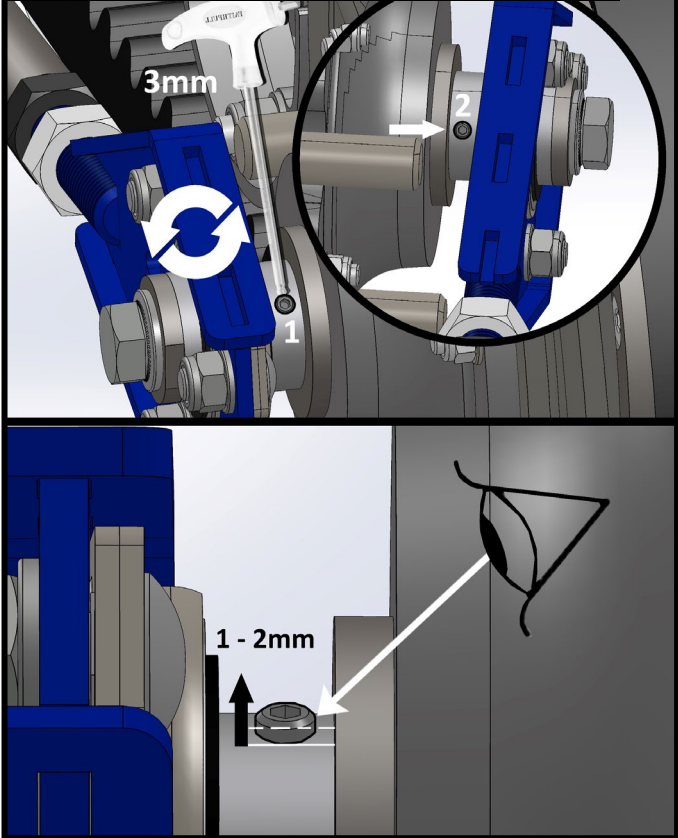

**7 – LOOSEN TIE ROD BEARING FASTENERS ON BOTH PULLEYS.**

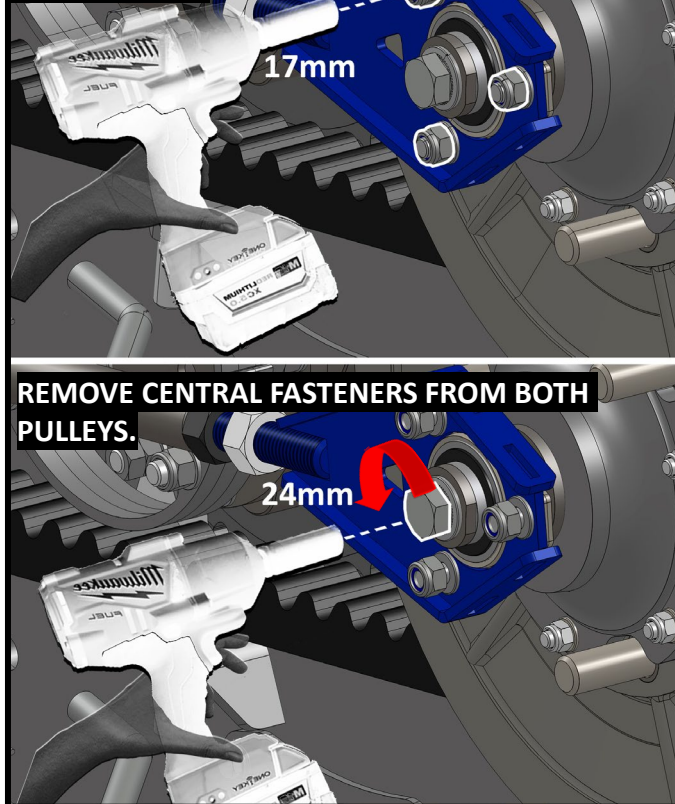

**8 – REMOVE THE TIE ROD FROM BOTH PULLEYS.**

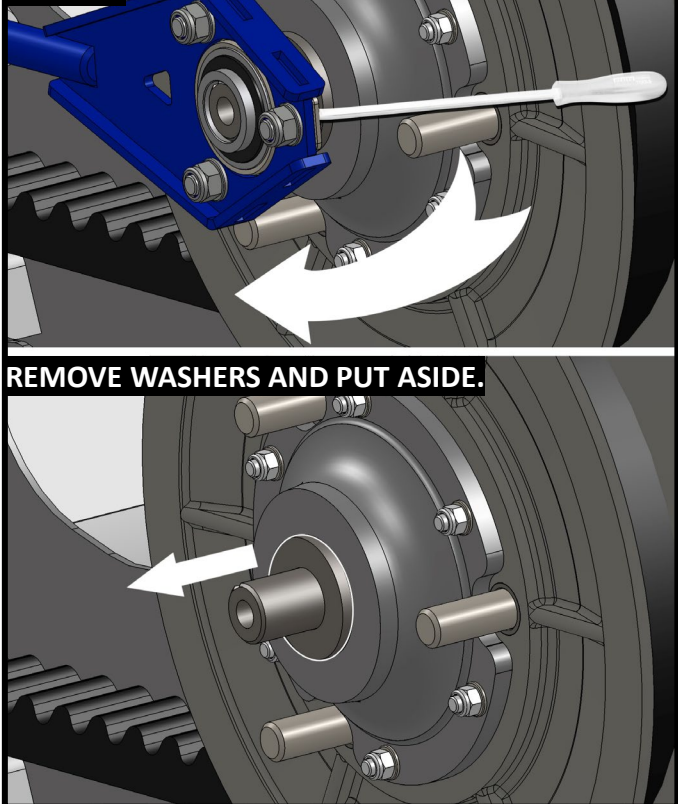

9 – LOOSEN GEARBOX ADJUSTER LOCKNUTS.

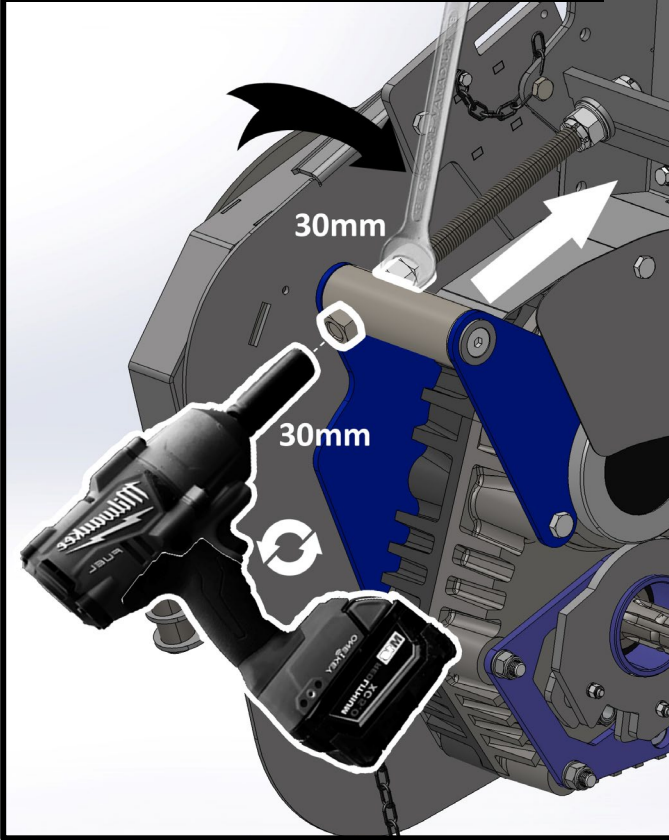

10 – PIVOT THE GEARBOX FORWARD.

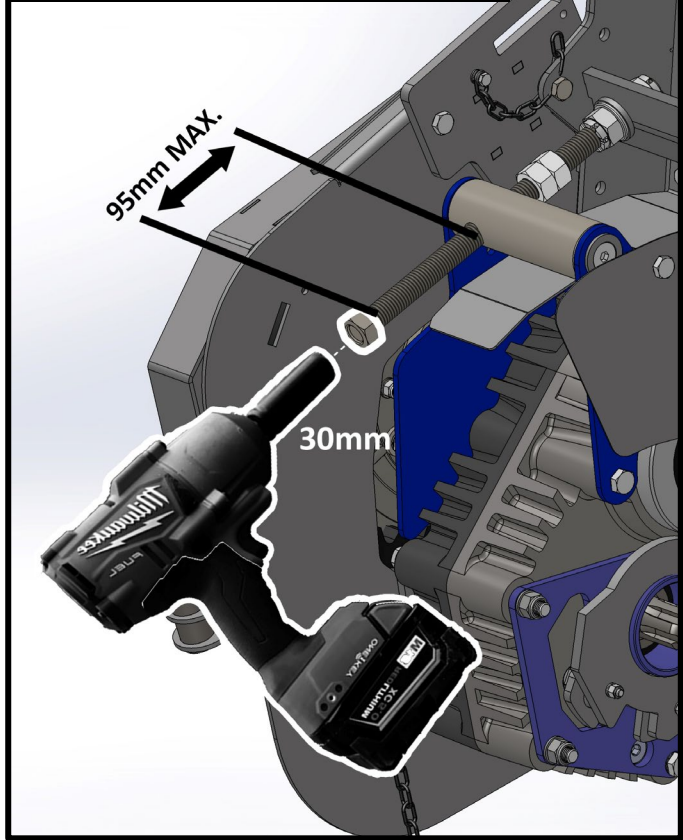

11 – REMOVE PULLEY ASSEMBLY WITH BELT.

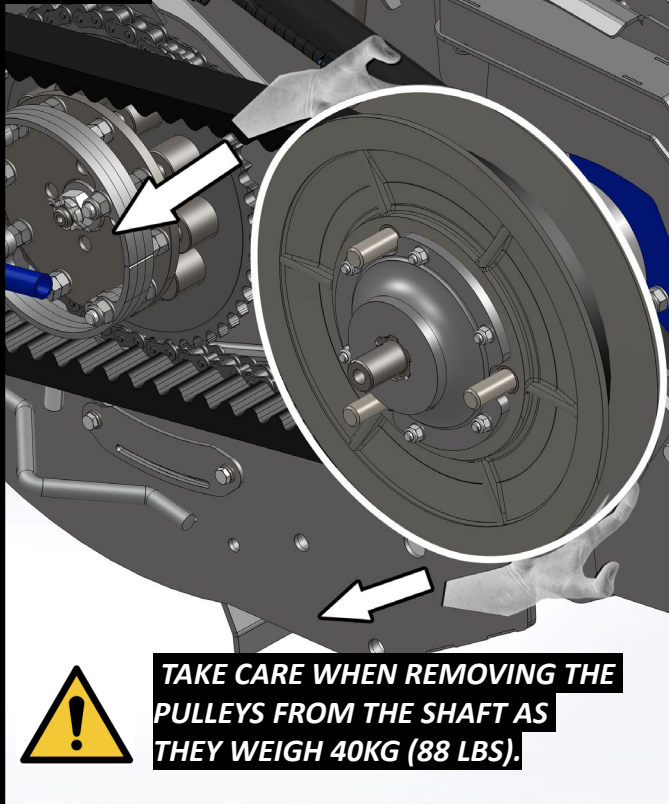

12 – REMOVE THE CAM BRACKET FASTENERS.

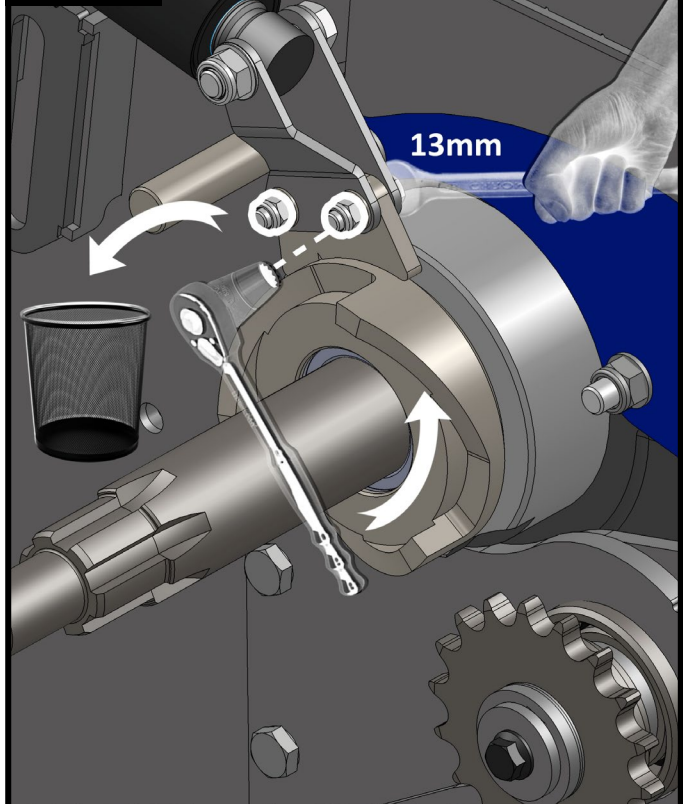

Machine / Model | Stripper header / CVS & XCV

Year / SN#

All Years

**13 – REMOVE ELECTRIC ACTUATOR WITH THE CAM BRACKETS.**

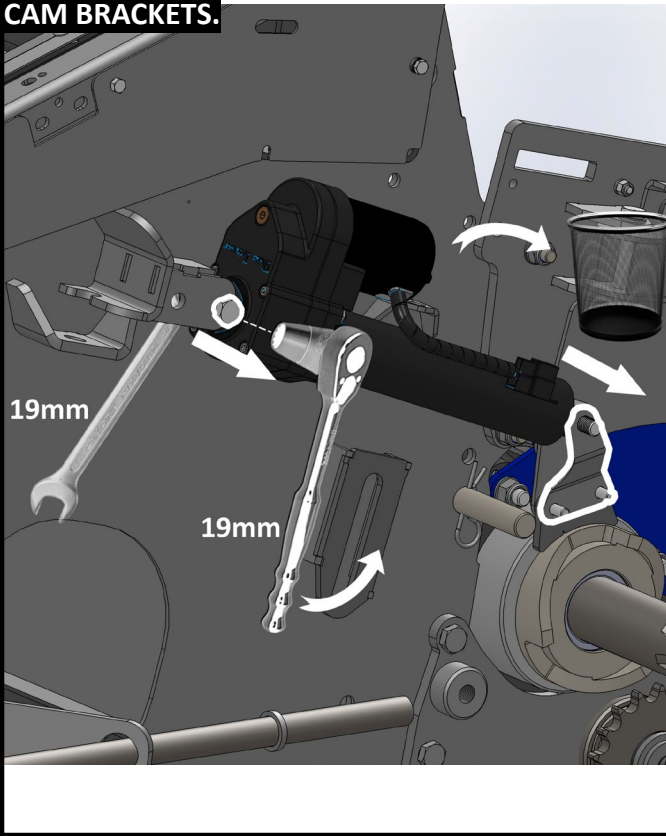

**14 – PRY OFF THE CAM & BEARING.**

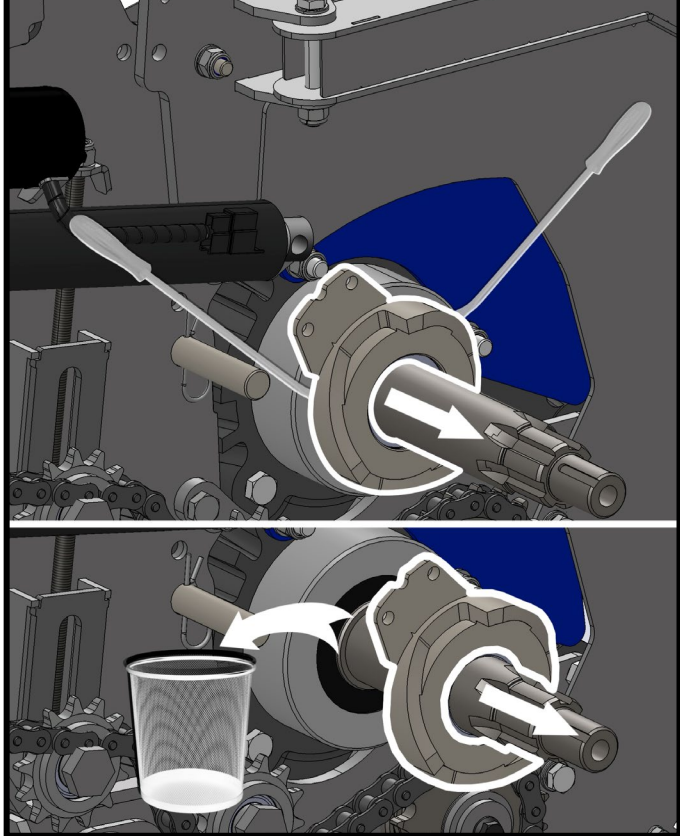

**15 – REMOVE THE CAM RETAINING BAR FROM THE MAINFRAME.**

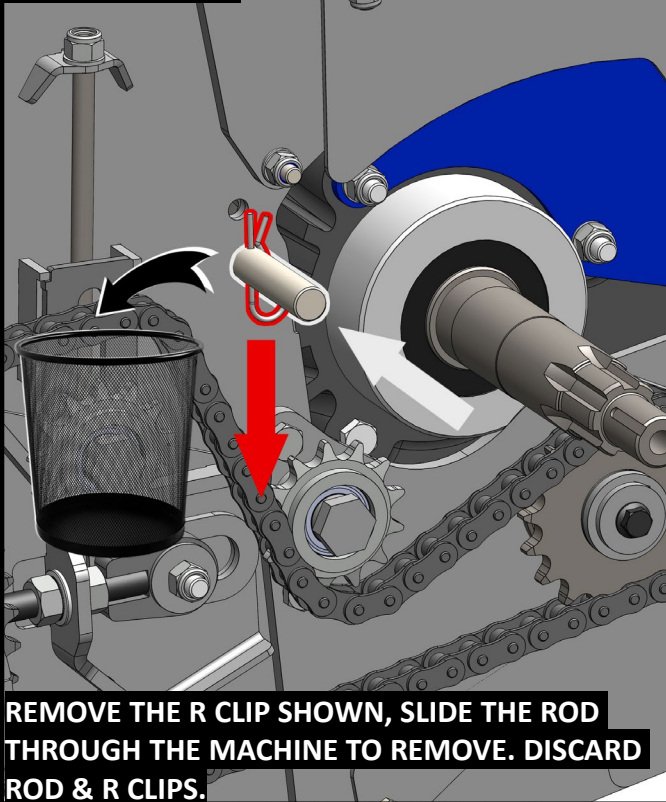

**16 – REMOVE GEARBOX ADJUSTER PARTS.**

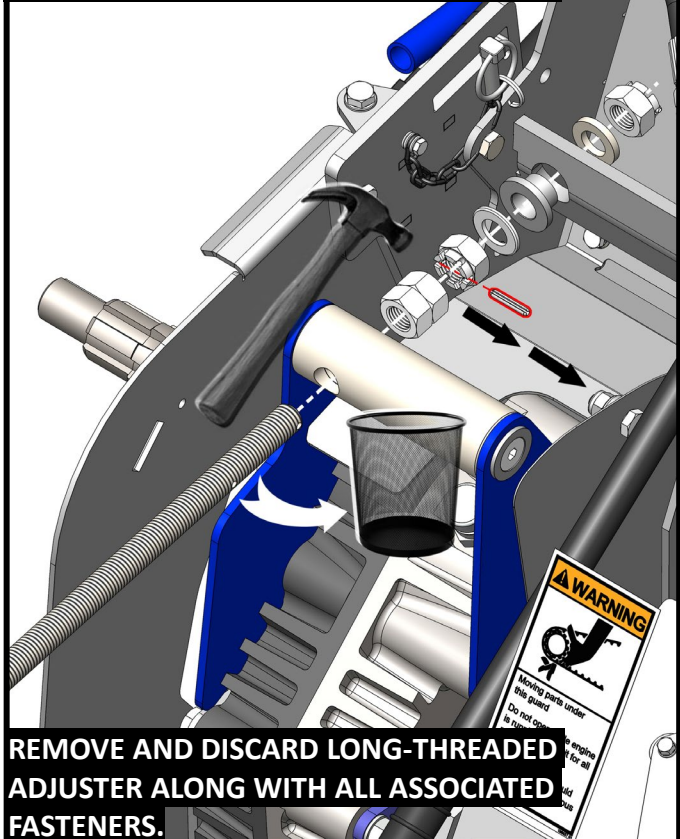

Machine / Model | Stripper header / CVS & XCV

Year / SN#

All Years

**17 – INSTALL THE NEW ADJUSTER.**

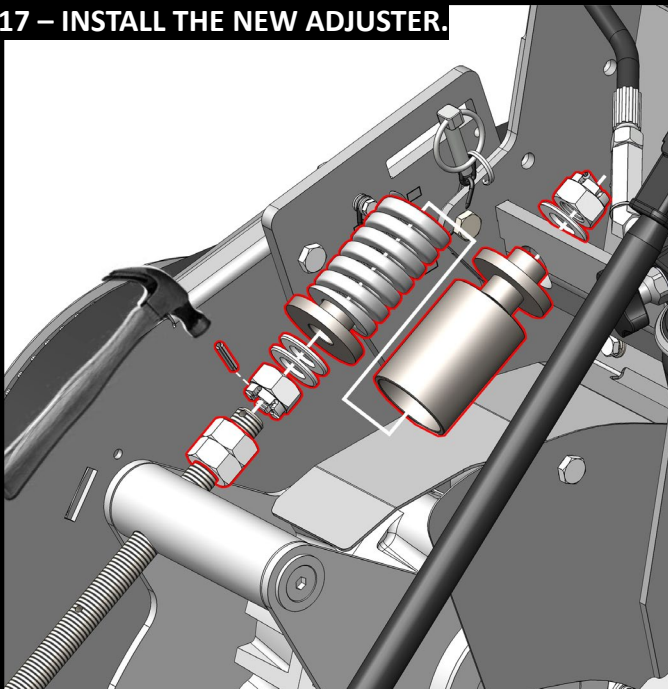

**NEW ROLL PINS NEED TO BE HAMMERED THROUGH TO LOCK THE CASTLE NUTS. ONCE INSTALLED, WIND ADJUSTER UNTIL THE GEARBOX IS IN THE FORWARD POSITION, THIS WILL ASSIST IN BELT INSTALLATION (STEP 33)**

**18 – PULL THE BELT ROUND, SPINNING THE ROTOR, UNTIL BELT IS LOOSE IN FRONT PULLEY THEN REMOVE.**

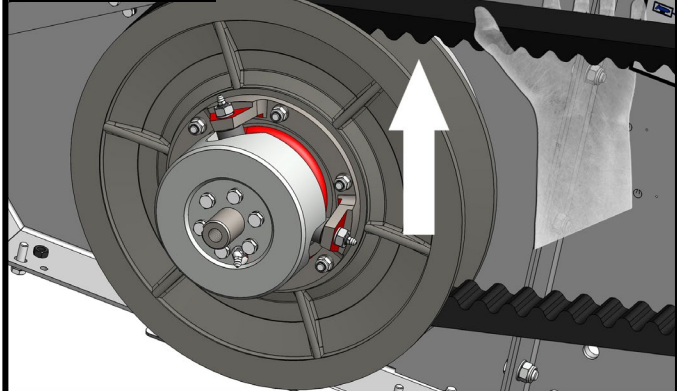

**REMOVE THE FRONT PULLEY.**

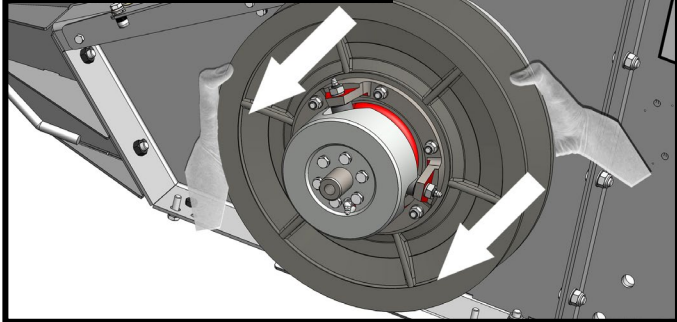

**19 – DISASSEMBLE FRONT PULLEY.**



**RELEASE THE SPRING TENSION SLOWLY, ENSURE NOT TO HAVE ALL THE SPRING LOAD ON ONE BOLT**

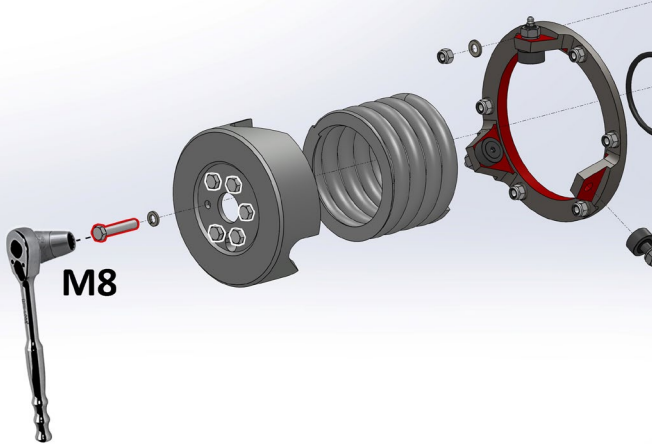

**LOOSEN THE 6x M8 FASTENERS SLOWLY TOGETHER IN ROTATION.**

**20 – SEPARATE PULLEY AND CENTRE HUB.**

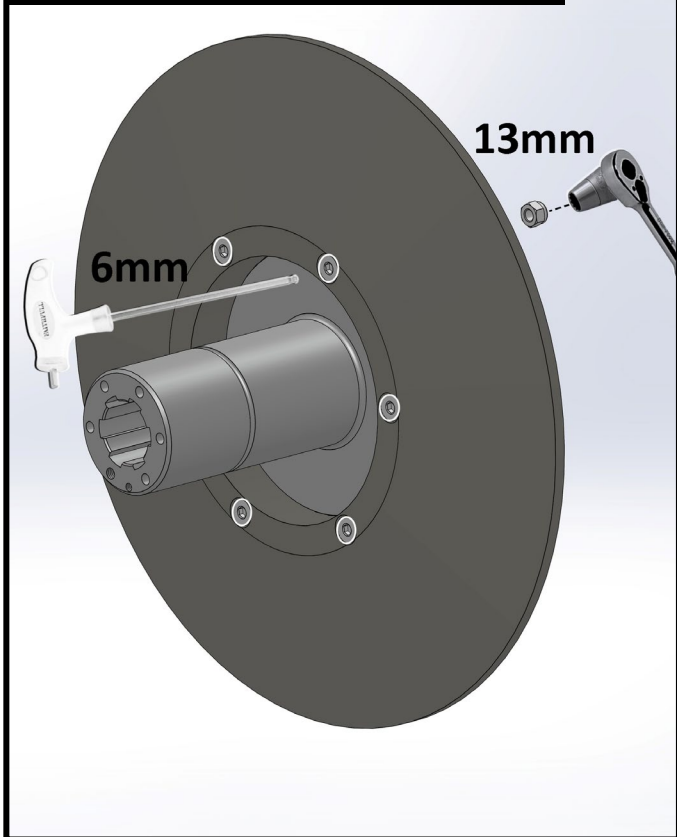

**21 – RETAIN THE FIXED MALE HUB FOR  
INSTALLATION IN NEW PULLEY, ALL OTHER  
COMPONENTS CAN BE DISCARDED.**

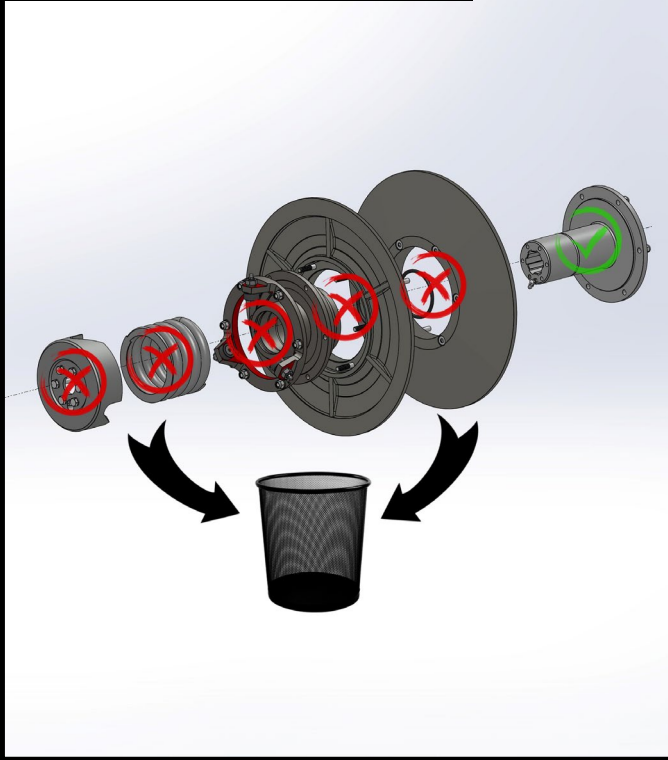

**22 – ASSEMBLE THE FRONT TOOTHED LAMINATE  
PULLEY TO THE HUB. BOLT TOGETHER WITH NEW  
M8 BOLTS. TIGHTENED TO TORQUE 25NM  
(18LBF.FT).**

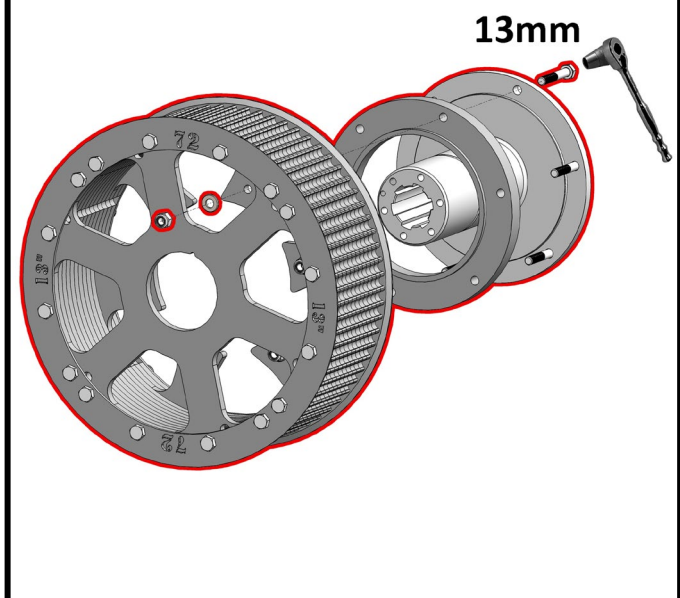

**REFER TO THE SPEED CHART TO DETERMINE  
WHAT PULLEY SIZE TO INSTALL ON THE FRONT  
HUB.**

**23 – GREASE THE SHAFT BEFORE ATTACHING THE  
FRONT PULLEY.**

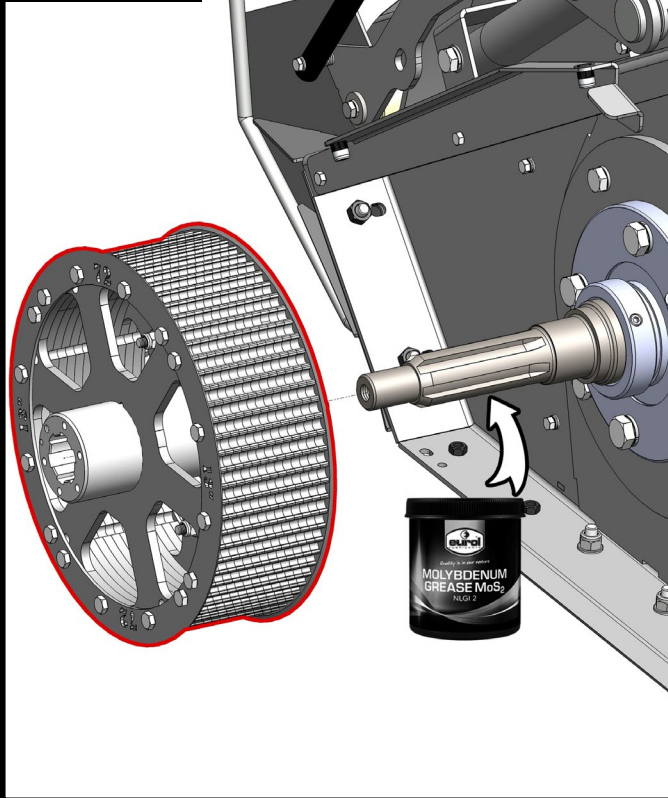

**24 – APPLY THE WASHER (190548 36) ALONG  
WITH WASHER KEPT ASIDE FROM DISASSEMBLY  
AND HALF OF THE TIE ROD.**

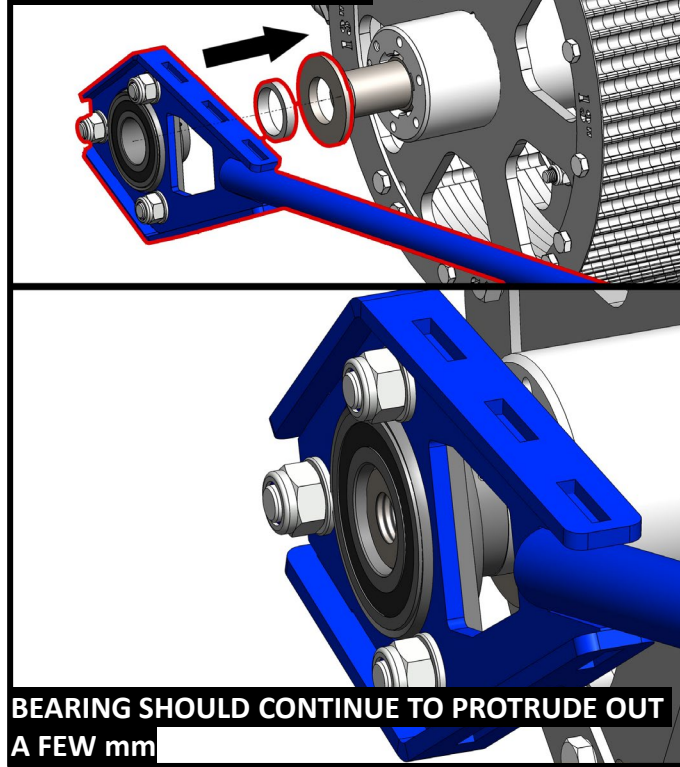

**BEARING SHOULD CONTINUE TO PROTRUDE OUT  
A FEW mm**



**25 – FASTEN WITH THE M16 SET SCREW TIGHTEN TO 225NM (166LBF.FT).**

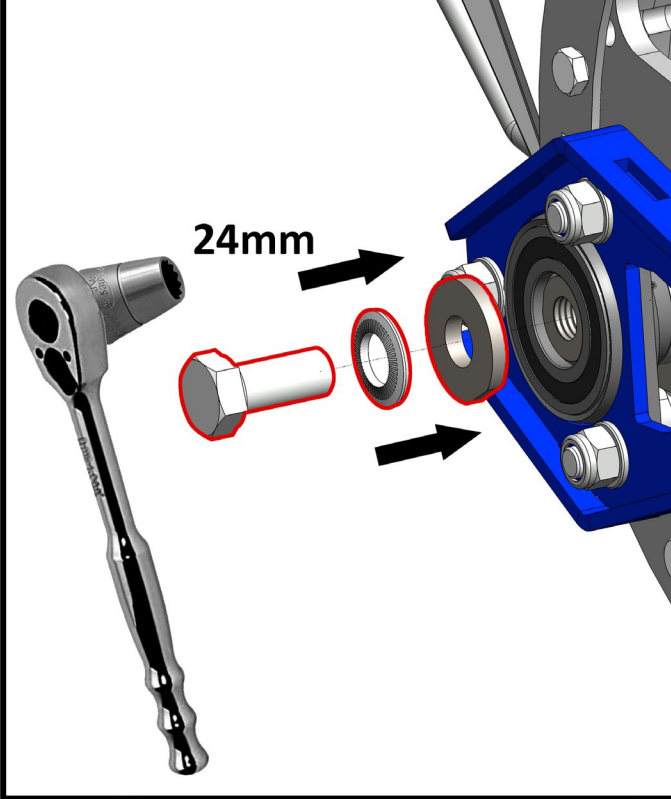

**26 – APPLY LOCTITE AND TIGHTEN THE GRUB SCREWS.**

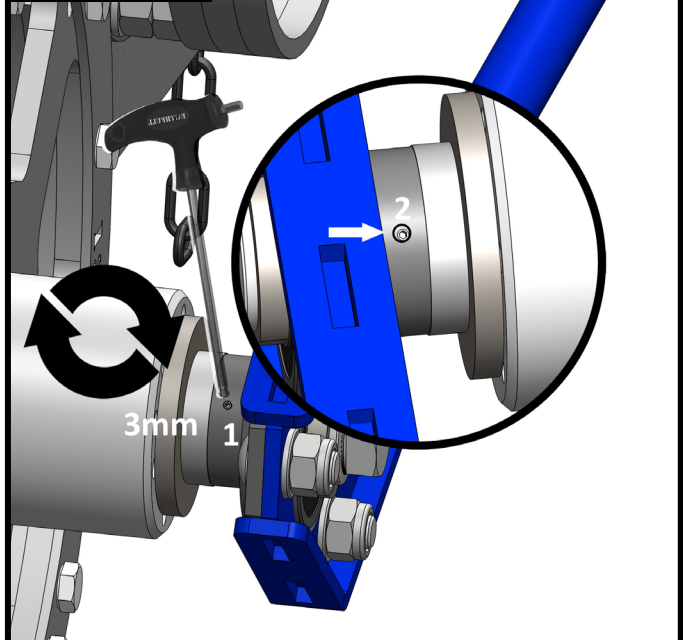

**IF THE MACHINE HAS A GROOVE IN THE FRONT SHAFT BENEATH THE TIE ROD BEARING, ENSURE ONE OF THE GRUB SCREWS IS ALIGNED AND TIGHTENED INTO THE GROOVE.**

**27 – DISASSEMBLE THE REAR PULLEY.**

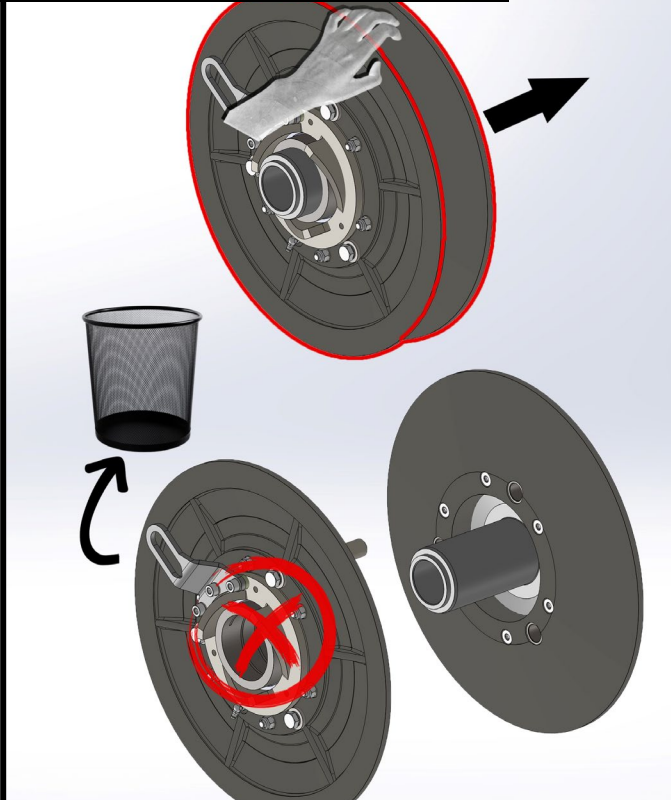

**ALL OTHER COMPONENTS CAN BE DISCARDED.**

**28 – SEPARATE PULLEY AND CENTRE HUB.**

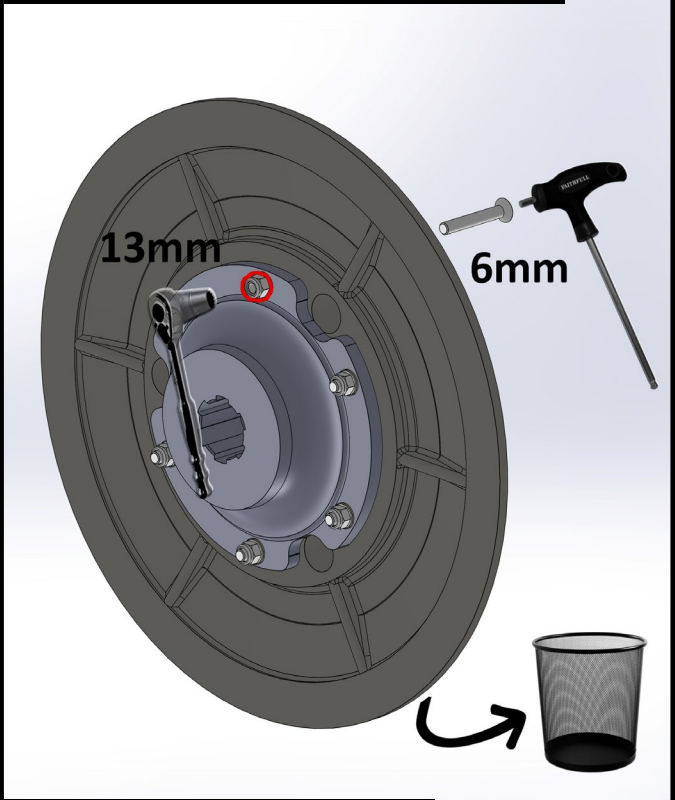

**THE PULLEY CAN BE DISCARDED.**

Machine / Model | Stripper header / CVS & XCV

Year / SN#

All Years

**29 – ASSEMBLE THE REAR TOOTHED LAMINATE PULLEY TO THE HUB. BOLT TOGETHER WITH NEW M8 BOLTS. TIGHTENED TO TORQUE 25NM (18LBF.FT). REFER TO THE SPEED CHART TO DETERMINE WHAT PULLEY SIZE TO INSTALL ON THE REAR HUB.**

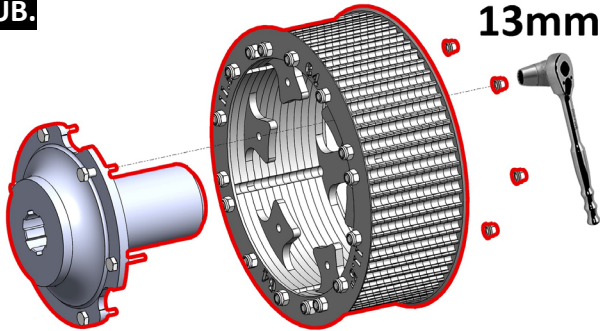

**PRIOR TO FITTING THE REAR PULLEY TO THE GEARBOX SHAFT CHANGE SPROCKET ON GEARBOX IF APPLICABLE. LOOK BACK TO PG2 FOR SPECIFIC COMBINE PARTS.**

**30 – GREASE THE GEARBOX SHAFT PRIOR TO FITTING THE REAR PULLEY.**

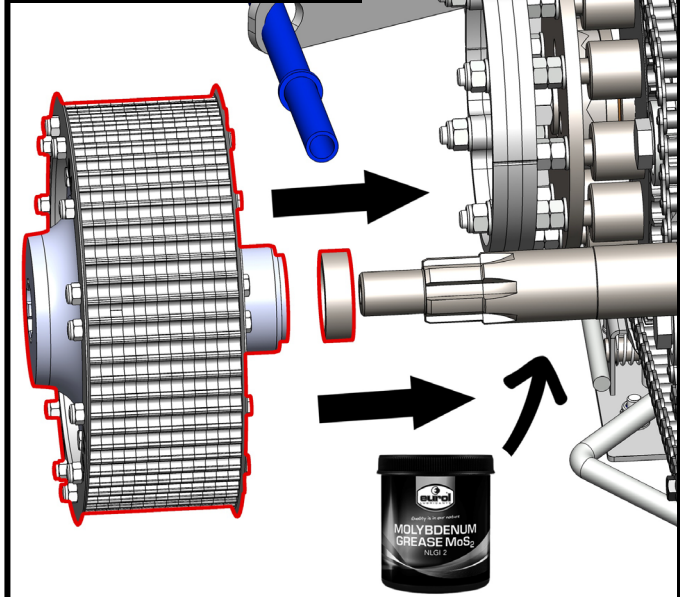

**ADD THE SPACER RING (292586 01) PROVIDED TO THE SHAFT FIRST, IT WILL BECOME TIGHT TOWARDS THE BOTTOM OF THE SHAFT BUT WILL PULL UP TO SHOULDER WHEN THE PULLEY IS BOLTED ON.**

**31 – SLIDE THE TWO HALVES OF THE TIE ROD TOGETHER AND PLACE THE TIE ROD BEARING ONTO THE GEARBOX SHAFT, FIT THE M16 BOLT INTO THE END.**

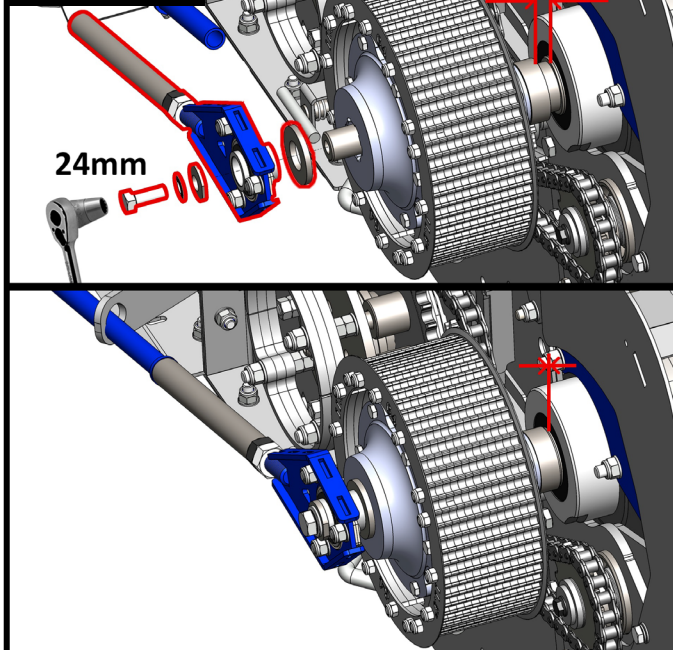

**THIS WILL PRESS THE PULLEY ONTO THE SHAFT AND LOCATE THE SPACER RING TO THE SHOULDER.**

**32 – APPLY LOCTITE AND TIGHTEN THE GRUB SCREWS.**

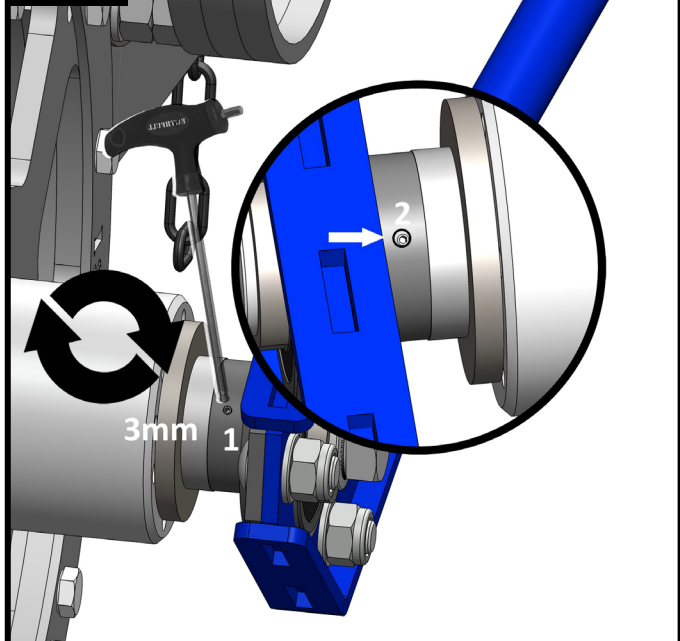

**IF THE MACHINE HAS A GROOVE IN THE REAR SHAFT BENEATH THE TIE ROD BEARING, ENSURE ONE OF THE GRUB SCREWS IS ALIGNED AND TIGHTENED INTO THE GROOVE.**

**33 – FIT NEW TOOTHED HTD BELT.**

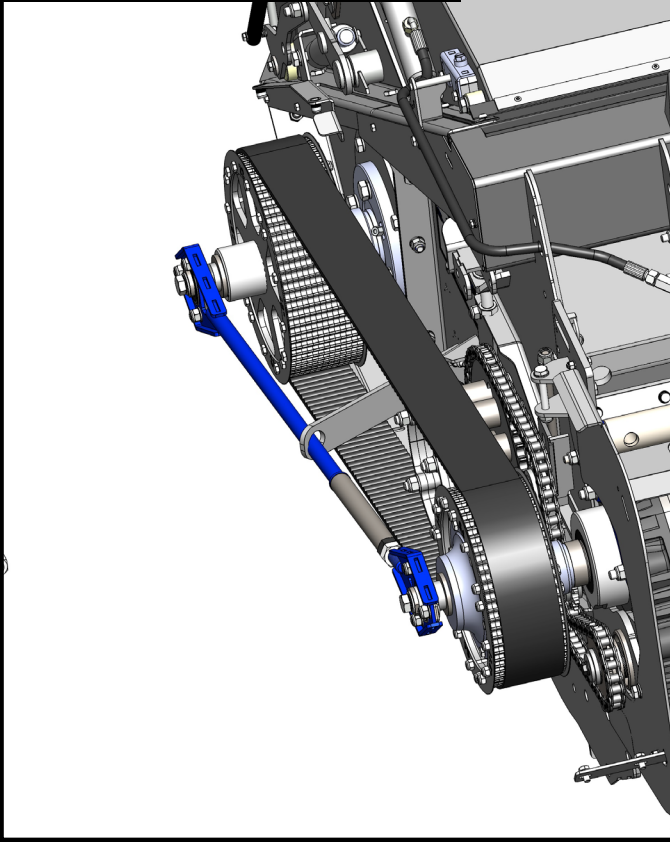

**34 – ADJUST THE GEARBOX PIVOT TO TENSION THE BELT.**

**DECREASES PULLEY CENTRES.**

**INCREASES PULLEY CENTRES.**

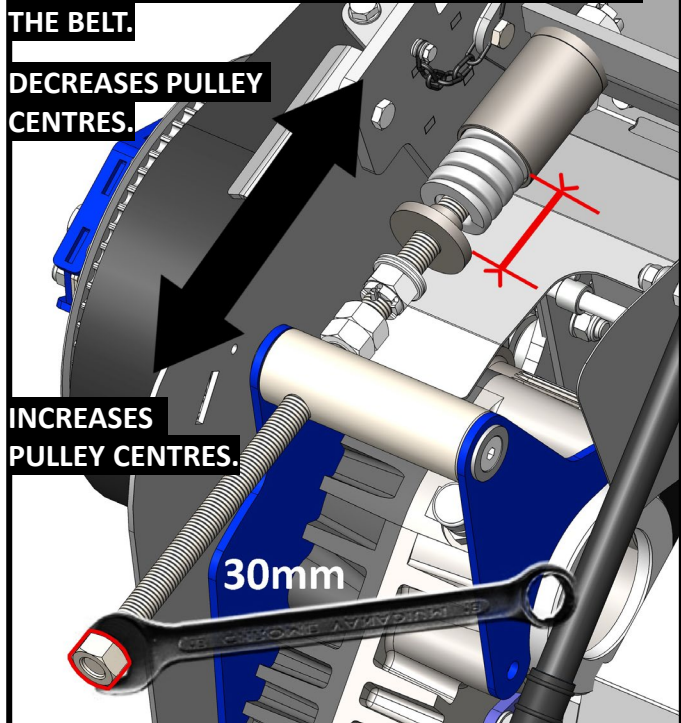

**ADJUST UNTIL THE SPRING IS TIGHTENED TO THE LENGTH OF THE SPACER TUBE. THEN LOCK OFF THE GEARBOX ADJUSTER WITH THE TWO NUTS.**

**35 – RESET THE TIE ROD & TIGHTEN THE LOCK NUT.**

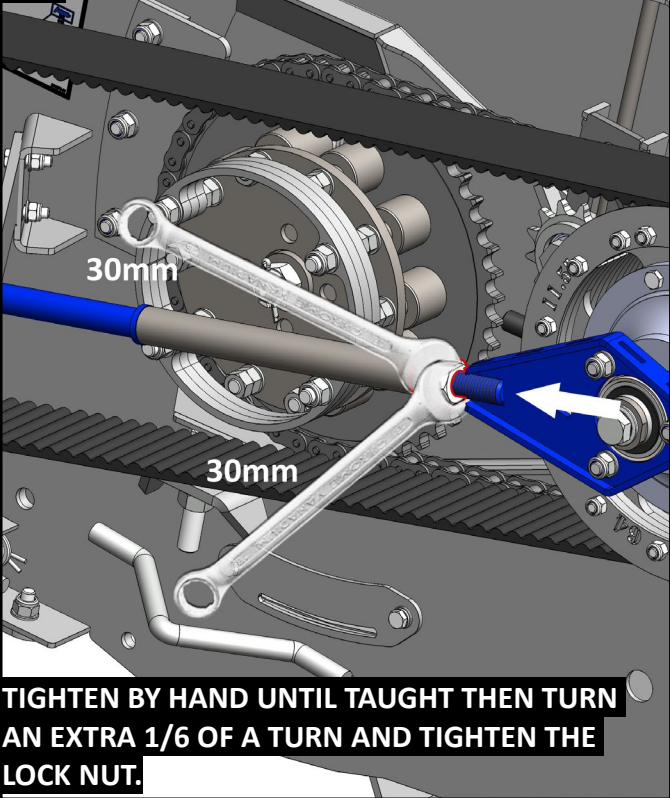

**36 – FASTEN THE TIE ROD BRACKET.**

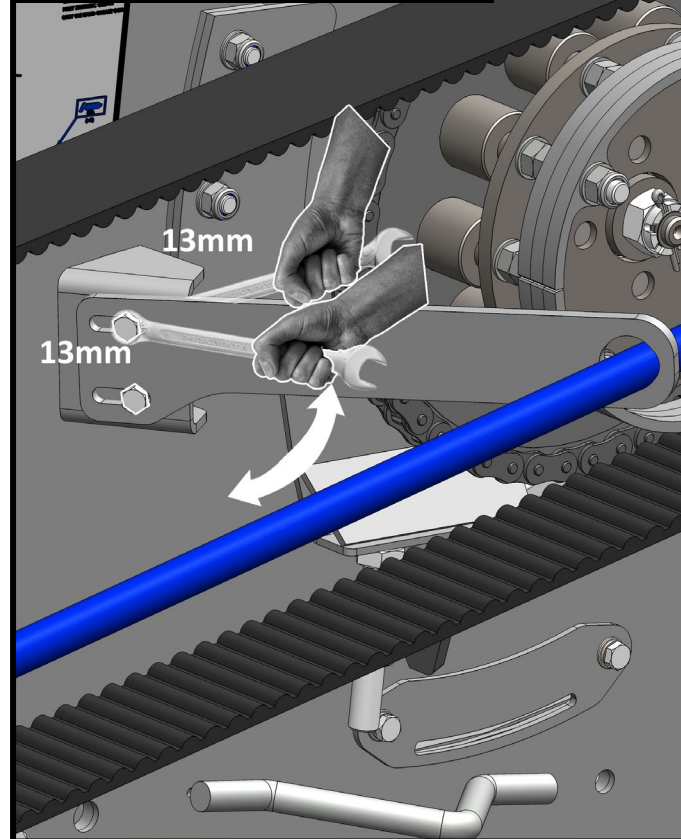

Machine / Model | Stripper header / CVS & XCV

Year / SN#

All Years

**37 – REMOVE THE M6 FASTENERS AND COVER PLATE.**

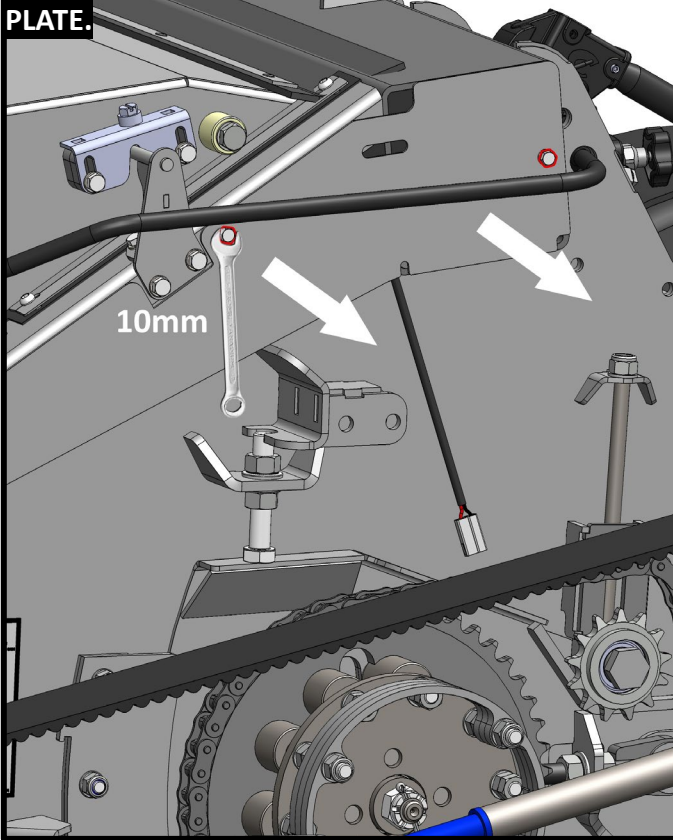

**38 – TIE UP THE ACTUATOR CABLE AND FEED INTO TOP BEAM THEN RE-ATTACH THE SIDE PLATE.**

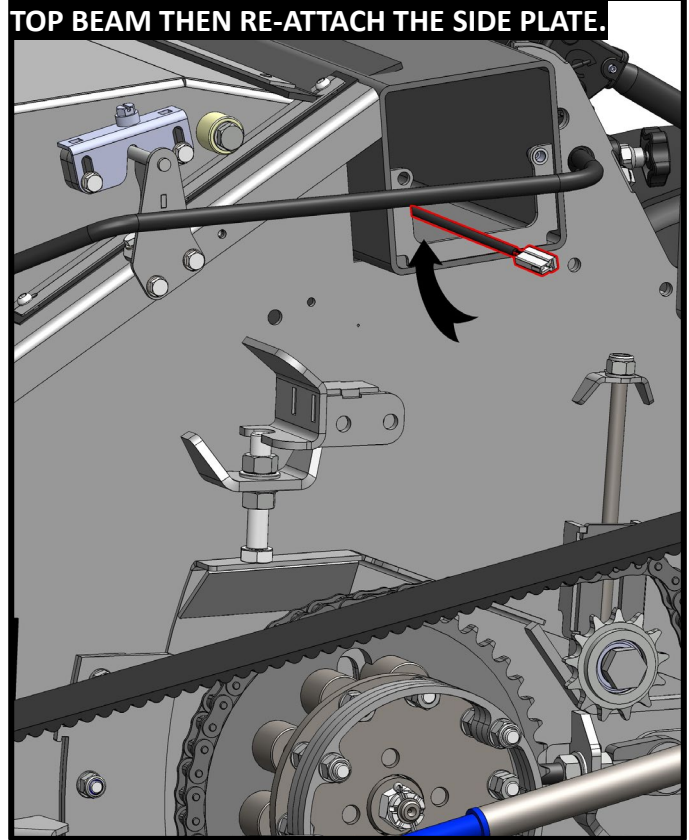

**39 – DISCONNECT THE 2 PIN ACTUATOR PLUG ONLY AT FEEDERHOUSE.**

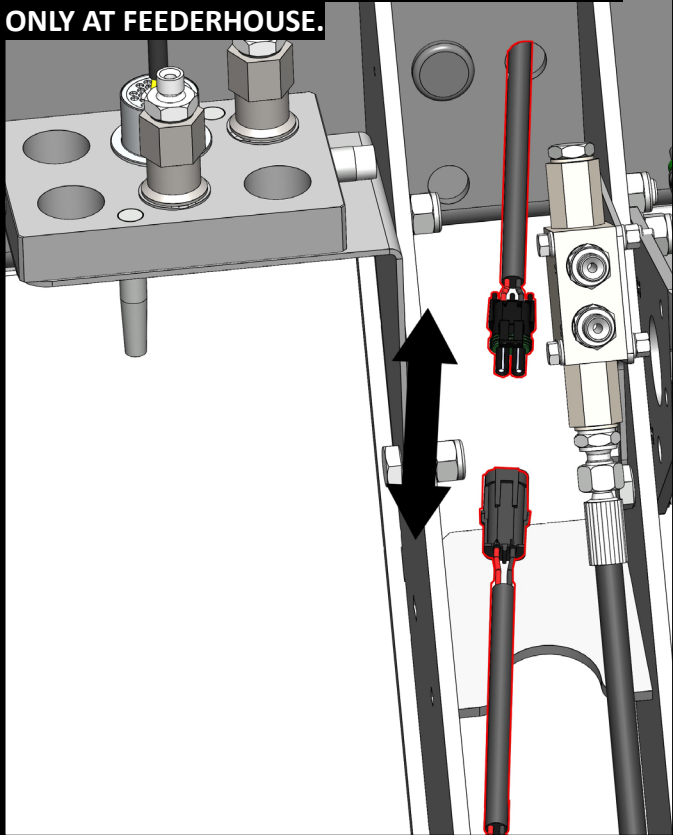

**40 – FEED CABLE BACK INTO HEADER, CABLE TIE IN SECURE POSITION.**

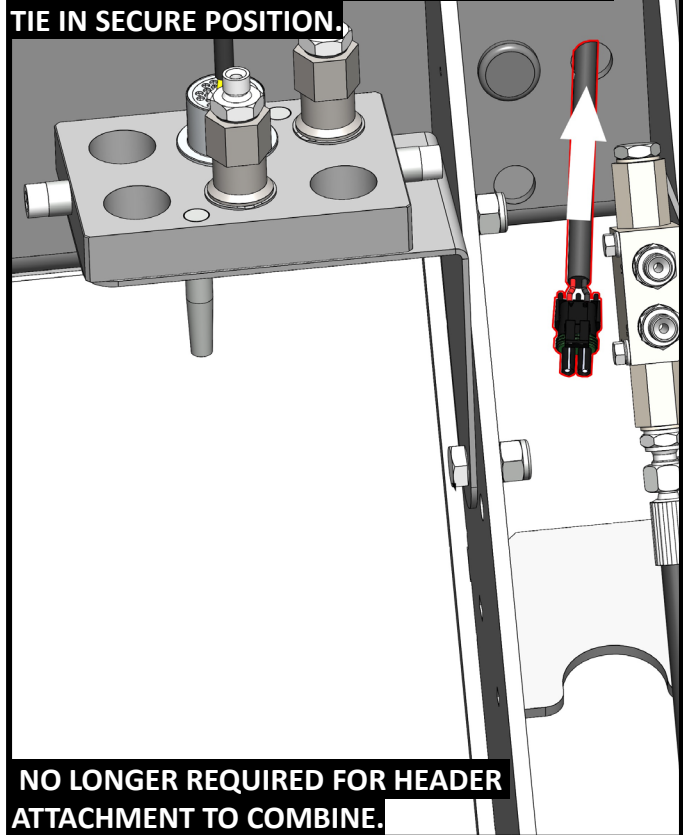

**NO LONGER REQUIRED FOR HEADER ATTACHMENT TO COMBINE.**

41 – TURN OVER THE DRIVE BY HAND.

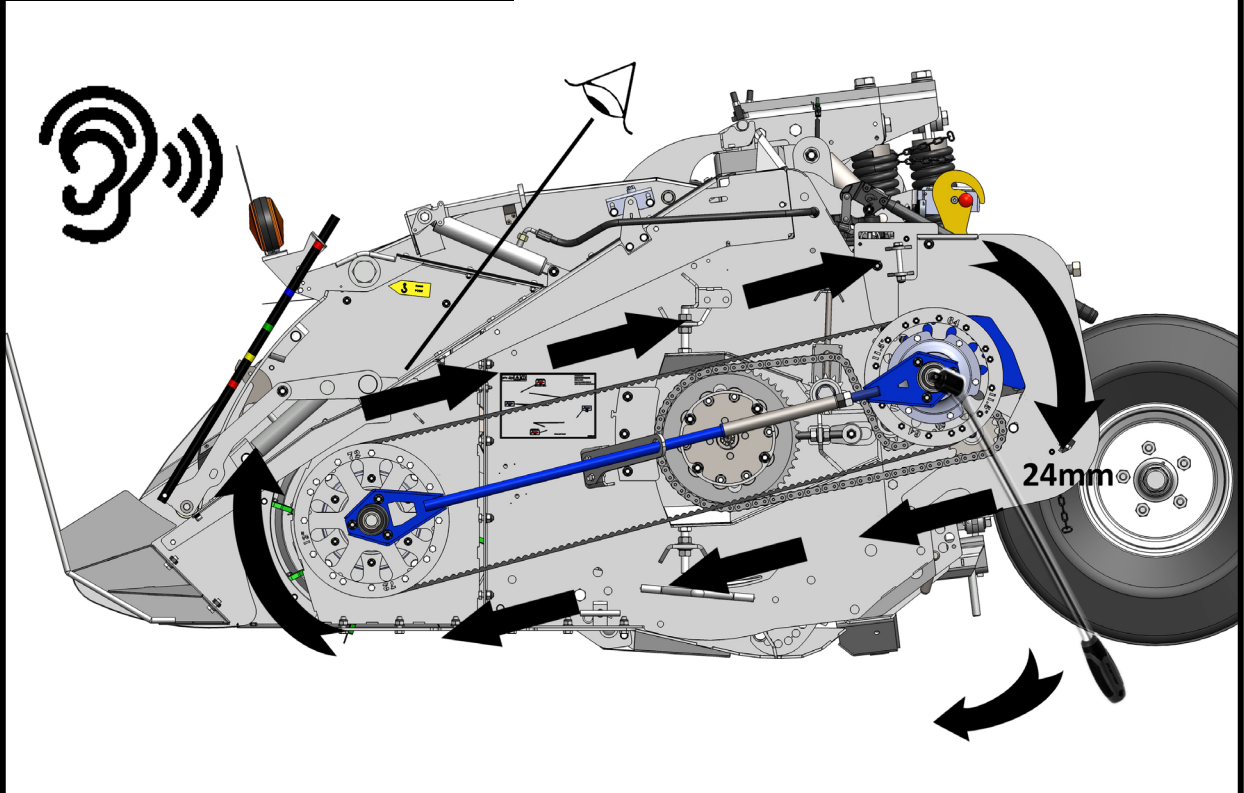

ROTATE THE DRIVE SYSTEM TO ENSURE NO COMPONENTS ARE CATCHING.

42 – FIT FRONT STEEL NOSE CONE, BY USING THE FOUR BOLTS.

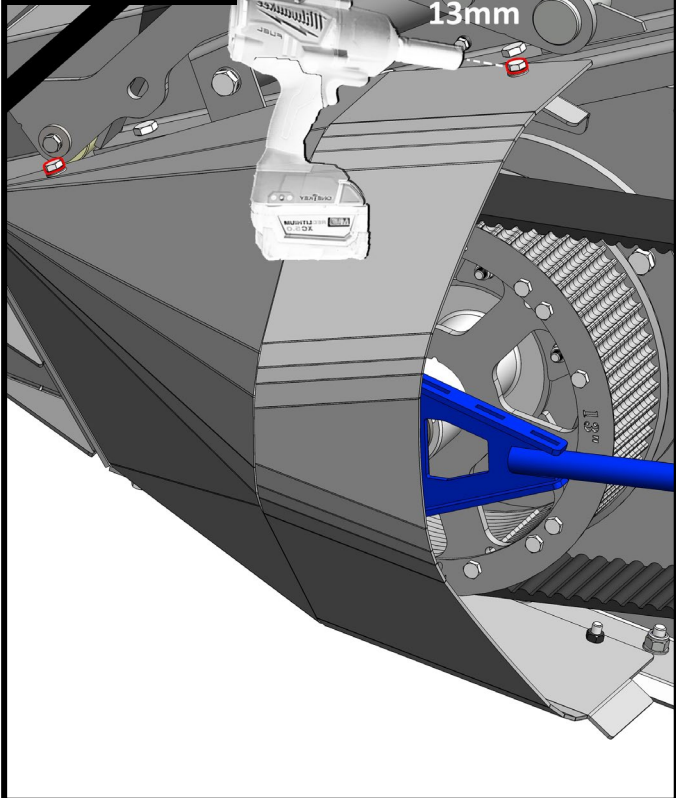

43 – REFIT THE GUARD.

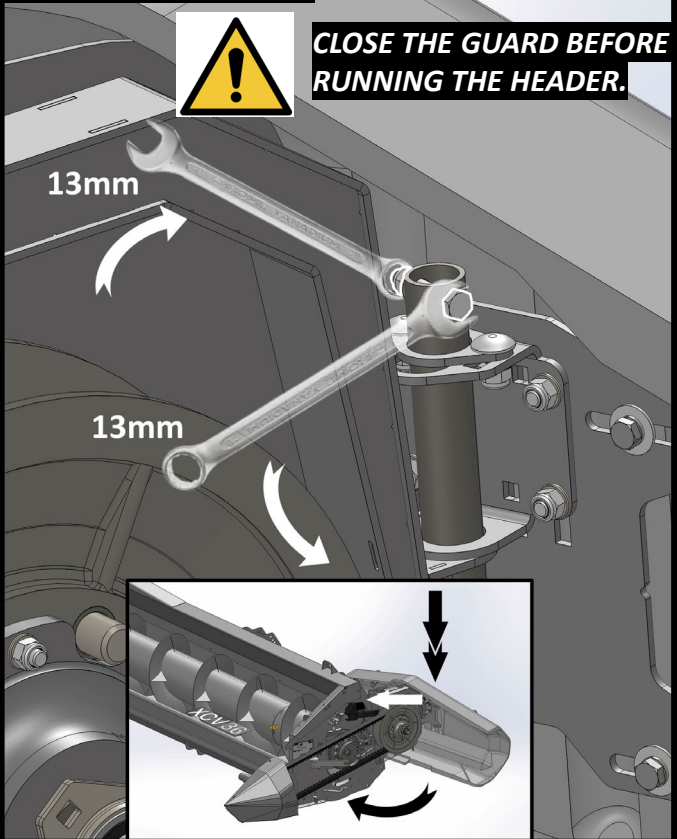

**SPEED RANGE DECAL:**

**USE THIS AS A GUIDE FOR THE SPEED RANGES YOU ARE LOOKING TO ACHIEVE.**

**SPEED SELECTION CHART LAMINATE PULLEYS**

		JOHN DEERE	CASE IH	AGCO	CLAAS
COMBINE DRIVE SHAFT SPEED (rpm)		500-680	500-670	630-850	540-740
AUGER SPEED RANGE (rpm)		150-200	150-200	150-200	140-190
ROTOR PULLEY	INPUT PULLEY	APPROXIMATE ROTOR SPEED (rpm)			
Ø 13"/72T	Ø 10"/56T	450-610	400-530	500-680	390-530
Ø 13"/72T	Ø 11.5"/64T	510-700	460-610	570-780	440-600
Ø 11.5"/64T	Ø 11.5"/64T	580-790	510-690	650-870	500-680
Ø 11.5"/64T	Ø 13"/72T	650-880	580-770	730-980	560-760
Ø 10"/56T	Ø 13"/72T	740-1000	660-890	830-1000	630-870

293182 01